

Draft of a tract of Land situate in  
 Conewango township Warren County  
 about one mile West of Conewango Creek  
 and about three fourths of a mile South  
 of the State Line  
 Surveyed 25<sup>th</sup> September 1820 for  
 Jehu Jones on improvement & set-  
 tlement.

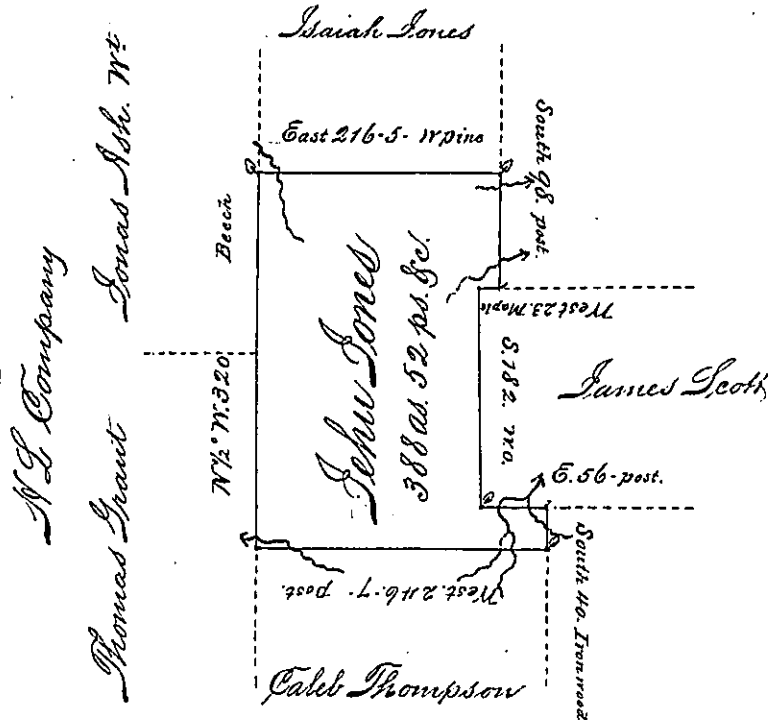

The above tract of land is now  
 situate in Pine Grove township

I do certify that the above is a true copy of a survey  
 entered in the Survey Book of Warren County, by John  
 Irwin Esq.

I do further certify that the above tract of land is  
 claimed by Marshall Jones & that the same nor no  
 part thereof is claimed by any other person to the best  
 of my knowledge & belief

Nov. 21<sup>st</sup> 1836

Andrew N. Ludlow Deputy  
 Surveyor of Warren County

IN TESTIMONY that the above is a copy of the original remaining on file in the  
 Department of Internal Affairs of Pennsylvania, made con-  
 formably to an Act of Assembly approved the 16th day of  
 February, 1833, I have hereunto set my Hand and caused  
 the Seal of said Department to be affixed at Harrisburg, this

first day of October 1895.

James W. Fatta  
 Secretary of Internal Affairs.